

FILM SIZES & VENTING



All shrink wrap covers must be ventilated to eliminate moisture, condensation, and mildew during the winter storage season. The number of vents needed to give a boat cross-flow ventilation will depend on the size and shape of the vessel. Remember – it is better to over ventilate the cover with additional vents rather than not installing enough. The following is an idea of the number needed by boat size:

Boat Size	# of Vents	Location
0'-18'	3	Two vents behind windshield and one at rear of cockpit.
19'-24'	4	Two vents in rear of cockpit and two forward of windshield.
25'-32'	6	Two vents in rear of cockpit, two at midsection, and two near bow.
33'-42'	8	Two vents in rear of cockpit, two on fly bridge, two amidship, and two near bow.
43' & Above	8-12	Same as above, with extras along the sides of the craft.

DS-683 "WEATHER-TIGHT" VENT INSTALLATION PROCEDURES:

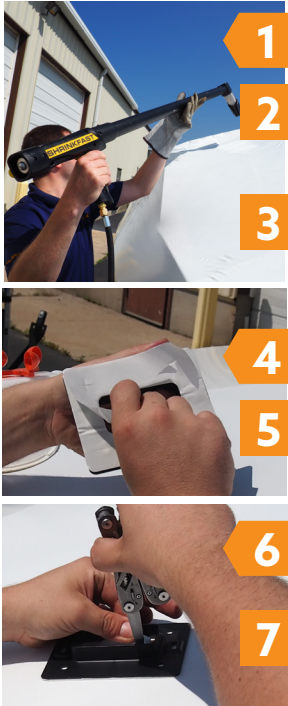

- 1** Completely shrink the cover before installing vents.
- 2** Vents may be installed on a horizontal or vertical surface. In areas receiving significant snow loads, vertical orientation is best as the vent will be less susceptible to snow cover-up.
- 3** Clean the cover if it is damp or dirty. Push against the cover to assure there is nothing behind the section you wish to install the vent which could impede air flow or be damaged by cutting (such as a seat cushion).
- 4** Remove the vent cover by squeezing the ends and remove the paper covering the adhesive backing on the base of the vent.
- 5** Affix the vent base to desired location and press firmly.
- 6** Carefully cut out the shrink wrap on the inside edge of the base. Reach inside and compress the shrink wrap against the adhesive base to insure proper adhesion.
- 7** Reinstall vent cover.

Film Size	Sq. Ft	Boat Length	Beam	# of Boats	# of Vents	Description
12' x 175'	2100	0'-16'	up to 7'	8	4	Works well for finishing boats & boats with low windshields
14' x 150'	2100	14'-19'	up to 8'	6	4	Great for runabout with full windshields
17' x 120'	2040	17'-24'	up to 8.5'	4	6	Excellent for pontoon boats and cuddy cabin cruisers
20' x 100'	2000	25'-29'	up to 8.5'	3	6	Good for express cruisers
24' x 115'	2760	25'-29'	up to 9'	3	6	Superb for express cruisers with arches or small flybridges
26' x 100'	2600	28'-31'	up to 10'	2	8	Very little waste on wider, taller flybridge boats under 32'
32' x 100'	3200	30'-38'	up to 11'	2	10	Super for wide and tall flybridge boats with an arch
40' x 100'	4000	44'-60'	up to 16'	1	12	Covers very large boats with arches and bridges with one piece of wrap
50' x 100'	5000	60'+	16'+	1	16	Excellent one piece coverage for the largest of boats with multiple levels, arches & bridges

*These sizes are approximate - each boat must be measured to assure that the proper size wrap is used. Always over ventilate and use the Shrinkfast® 998 for best results. Call 800.968.5147 with questions or comments.