

FULL ENCAPSULATION

The following are some of the most frequently asked questions when fully encapsulating and shrink wrapping an object for storage or transportation. Here we highlight how to properly measure for your roll width while also providing tips to prevent holes with some of the great products offered by Dr. Shrink.



SCAN WITH YOUR SMARTPHONE TO VIEW OUR HOW-TO VIDEO



MEASURING FILM SIZE AND CREATING THE ENCAPSULATION

To fully encapsulate an object, you will need to encase it completely in shrink wrap. Here are some quick tips to help you determine your roll widths needed for your project. For illustrative purposes (in both images and our how-to video) we are showing a fork lift being wrapped.

DETERMINE BASE ROLL WIDTH SIZE STEP #1

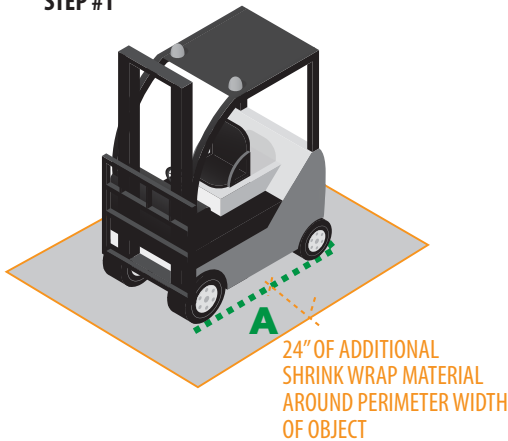

$A + 24" + 24" = \text{BASE WIDTH ROLL SIZE}$

DETERMINE COVER ROLL WIDTH SIZE STEP #2

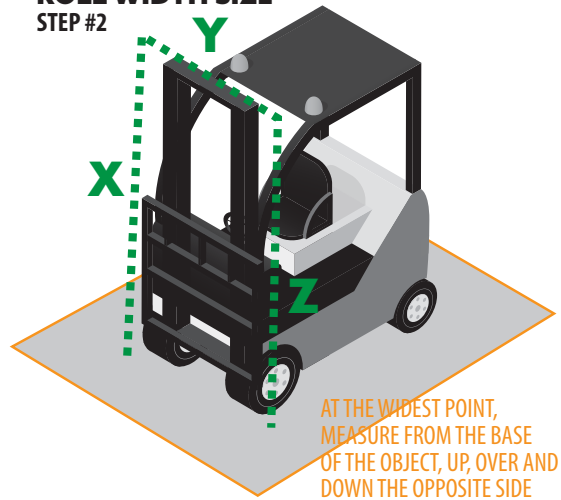

$X + Y + Z = \text{COVER ROLL WIDTH SIZE}$

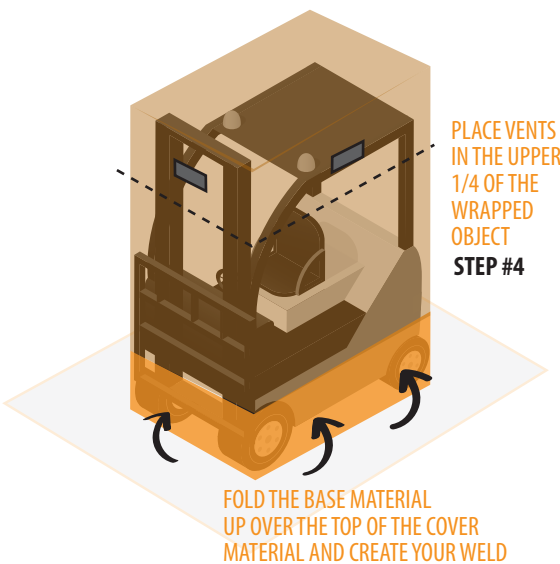

PLACE VENTS IN THE UPPER 1/4 OF THE WRAPPED OBJECT
STEP #4

FOLD THE BASE MATERIAL UP OVER THE TOP OF THE COVER MATERIAL AND CREATE YOUR WELD

CREATING YOUR SEAMS STEP #3

ONCE YOUR WRAP IS DRAPED OVER YOUR OBJECT, CREATE SEAMS LIKE YOU ARE WRAPPING A PRESENT, TRIMMING ANY EXCESS WRAP. WELD ALONG THESE SEAMS.

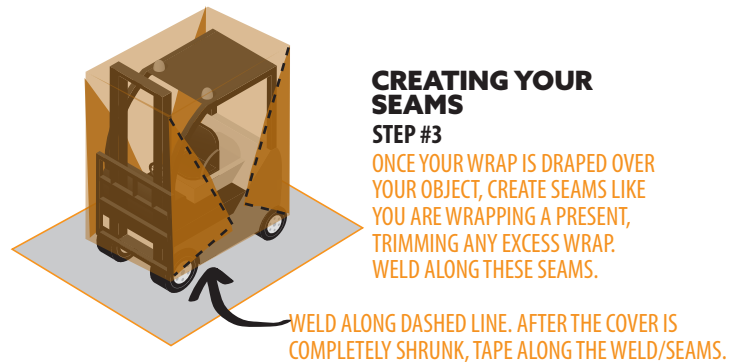

WELD ALONG DASHED LINE. AFTER THE COVER IS COMPLETELY SHRUNK, TAPE ALONG THE WELD/SEAMS.



ENCAPSULATING & YOUR VENT PLACEMENT



OUR LIFTING LUG COVER IS IDEAL FOR FULL ENCAPSULATION PROJECTS WHEN ACCESS IS NEEDED TO ANCHOR/LIFT POINTS ON THE OBJECTS